

## Product Code

# 8394/B

Valve Core  
Internal Spring  
PS = 35 bar

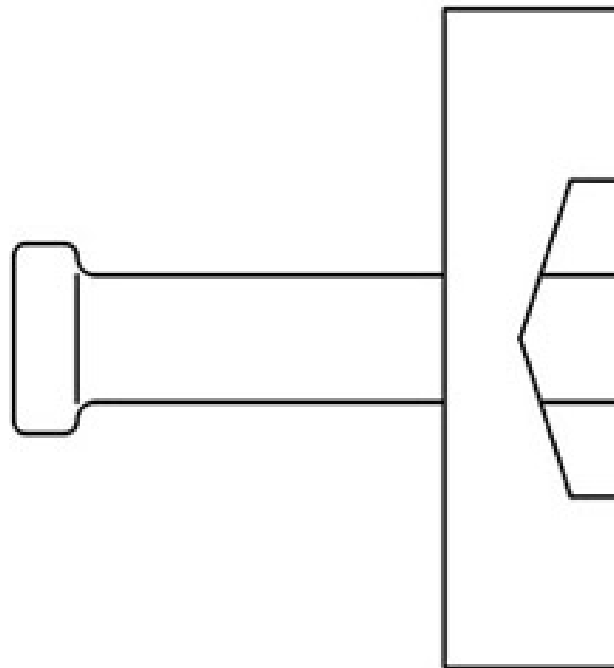

## Product use

Accessories for use with the following ASHRAE 34:2019 refrigerants, Class A1, A2L, or A3:

- HCFC (R22)
- HFC (R134a, R32, R404A, R407C, R410A, R507)
- HFO and HFO/HFC blends (R1234ze, R1234yf, R448A, R449A, R450A, R452A, R513A, R515A, R515B)
- HC (R290, R600, R600a, R1270)
- R744

Operating pressures vary based on the refrigerants.

## Product Details

Static pressure [bar]	35
Working pressure [bar]	30
TS [°C] min.	-35
TS [°C] max.	+100
Use	R22HFC
Package pcs	100

## Notes where expressly stated

- (1) Inside spring
- (2) Outside spring
- (3) NB: No use with R22