

## Product Code

# 8394/B1

Valve Core  
Internal Spring  
PS = 50 bar

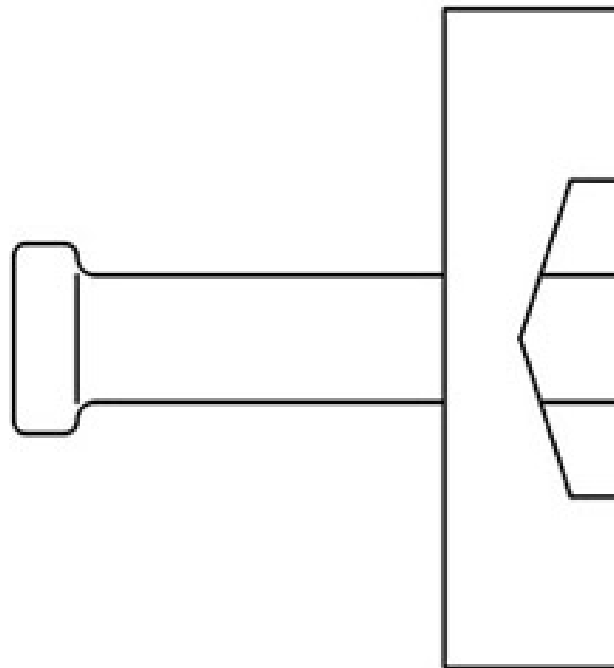

### Product use

Accessories for use with the following ASHRAE 34:2019 refrigerants, Class A1, A2L, or A3:

- HCFC (R22)
- HFC (R134a, R32, R404A, R407C, R410A, R507)
- HFO and HFO/HFC blends (R1234ze, R1234yf, R448A, R449A, R450A, R452A, R513A, R515A, R515B)
- HC (R290, R600, R600a, R1270)
- R744

Operating pressures vary based on the refrigerants.

### Product Details

|                        |          |
|------------------------|----------|
| Static pressure [bar]  | 60       |
| Working pressure [bar] | 55       |
| TS [°C] min.           | -25      |
| TS [°C] max.           | +150     |
| Use                    | HFCHFOHC |
| Package pcs            | 100      |

### Notes where expressly stated

- (1) Inside spring
- (2) Outside spring
- (3) NB: No use with R22