

## Product Code

# 6570N/6

Ball Valve

3/4"ODS  
PS = 50 bar - 726 PSI

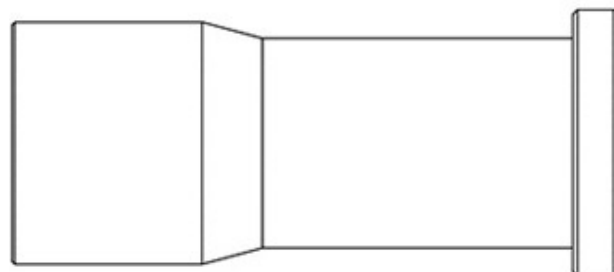

**POLYHEDRA**

### Product use

Accessories for use with the following ASHRAE 34:2019 refrigerants, Class A1, A2L, or A3:

HFC (R134A, R32, R404A, R407C, R410A, R507)

HFO (R1234YF, R1234ZE)

HFO + HFC (R448A, R449A, R450A, R452A, R452B, R454A, R454B, R454C, R455A, R513A, R515A, R515B)

HC (R290, R600, R600A, R1270)

### Product Details

Connections ODS Ø [in.] 3/4"

Connections ODS Ø [mm]

Ball port Ø [mm] 15

Kv [m<sup>3</sup>/h] 17

PS [bar] 50

MWP [psi] (1) 726

TS [°C] min. -40

TS [°C] max. +150

Package pcs 16

### Notes where expressly stated

*Castel non si assume alcuna responsabilità per eventuali errori nei cataloghi, opuscoli e altro materiale stampato o indicato nel sito Castel.it. Castel si riserva il diritto di modificare i propri prodotti senza preavviso. Tutti i marchi in questo materiale sono di proprietà di Castel. Tutti i diritti riservati.*

*Castel assumes no responsibility for any errors in catalogs, brochures and other material printed or indicated on the Castel.it website. Castel reserves the right to modify its products without notice. All trademarks in this material are the property of Castel. All rights reserved.*

NB: proportional flow versions available  
(1): according to UL approval