

Product Code

6577E/2

Ball Valve CO2

1/4" ODS
PS = 130 bar - 1885 PSI

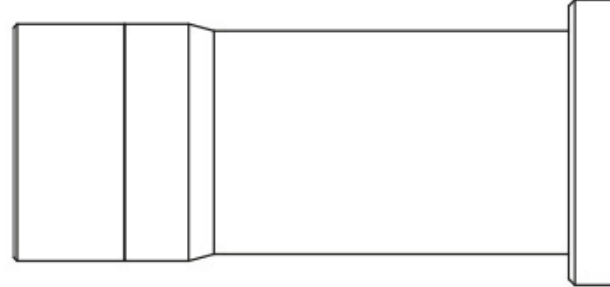

Product use

Accessories for use with refrigerant R744.

Product Details

Connections ODS Ø [in.] 1/4"

Connections ODS Ø [mm]

Ball port Ø [mm] 10

Kv [m³/h] 0,8

PS [bar] 130

MWP [psi] (1) 1885

TS [°C] min. -40

TS [°C] max. +150

Package pcs 25

Notes where expressly stated

(1): according to UL approval

(2): not UL approved

NB: proportional flow versions available