

## Product Code

# 6570/M15

Ball Valve

15mm ODS<br>PS = 45 bar - 600 PSI

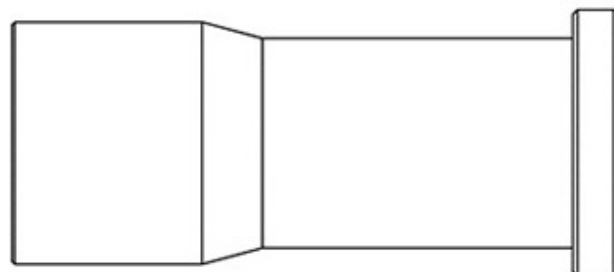

CLASSIC

### Product use

Accessories for use with the following ASHRAE 34:2019 refrigerants, Class A1:

HCFC (R22)

HFC (R134a, R404A, R407C, R410A, R507)

HFO (R1234ze)

HFO + HFC (R448A, R449A, R450A, R452A, R513A, R515A, R515B)

### Product Details

#### Connections ODS Ø [in.]

Connections ODS Ø [mm] 15

Ball port Ø [mm] 15

Kv[m<sup>3</sup>/h] 17

PS[bar] 45

MWP [psi] (1) 600

TS[°C] min. -40

TS[°C] max. +150

Package pcs 16

### Notes where expressly stated

(1): according to UL approval

Castel non si assume alcuna responsabilità per eventuali errori nei cataloghi, opuscoli e altro materiale stampato o indicato nel sito Castel.it. Castel si riserva il diritto di modificare i propri prodotti senza preavviso. Tutti i marchi in questo materiale sono di proprietà di Castel. Tutti i diritti riservati.

Castel assumes no responsibility for any errors in catalogs, brochures and other material printed or indicated on the Castel.it website. Castel reserves the right to modify its products without notice. All trademarks in this material are the property of Castel. All rights reserved.

NB: proportional flow versions available